

Figure 5. Important mounting dimensions for outward swing 400 operators, top view

Dimensions, In. (cm)			
	400 Standard, Rapid, Slow and EG	400 Long (EG)	
	90°	115°	125°
A	5 (12.7)	5 3/4 (14.6)	4 3/4 (13)
B	5 (12.7)	7 (17.8)	6 5/8 (17)
C	27 9/16 (70)	32 3/4 (93.19)	32 3/4 (83.19)
D	No Limit	No Limit	No Limit
E	Must be less than A		

ATTACH THE OPERATOR TO THE GATE

Re-attach the operator to the mounting brackets. Once the operator is mounted and level, remove the vent screw from the bottom of the rear flange. (See Figure 1)

WARNING! Failure to remove the vent screw may result in erratic operation of the operator or blown seals.

Slowly move the gate open and close.

WARNING! The piston should not bottom out in either direction. Doing so will seriously damage the operator.

Be sure that the gate reaches the positive stop before the piston bottoms out. Adjust the swivel joint if necessary.

Once the operator is secure, attach the protective cover to the front flange with the tie rods and end cap provided.

Note: Lubricating the threads of the protective cover tie rods can prevent them from freezing up and breaking if operator is ever removed for service.

Once the protective cover is installed, swing the gate to ensure that it does not contact the cover at any point of the swing.

Re-engage the operator by turning the red knob clockwise until snug. (see Figure 3)

ADJUST THE OPERATOR PRESSURES

The 400 Operator has an anti-crushing safety device (operator pressure) which limits the operator's force if an obstacle is encountered while the gate is moving.

To adjust the anti-crushing safety device do the following procedures:

- Lift the key lock cover (figure 3) and insert the manual release key.
- Turn the key 90° clockwise to open the locking cap cover.
- Lift up the cover.
- Refer to figure 6 for the following procedures)
- Remove the screw (3) which secures the knob (4) and then remove the knob.
- Locate the pressure adjustment (by-pass) screws (5 and 6)
- Opening pressure screw (green wording = gate opening direction)
- Closing pressure screw (red wording = gate closing direction)

NOTE: FAAC recommends the maximum pressure to be set at 33lbs at the leading edge of the gate leaf.

WARNING: Do Not Exceed the UL regulations of 45lbs. At the leading edge of the gate leaf

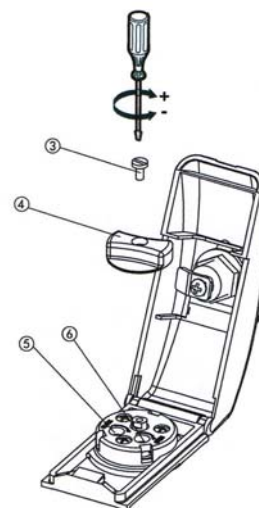

Figure 6. Locking Cap Assembly

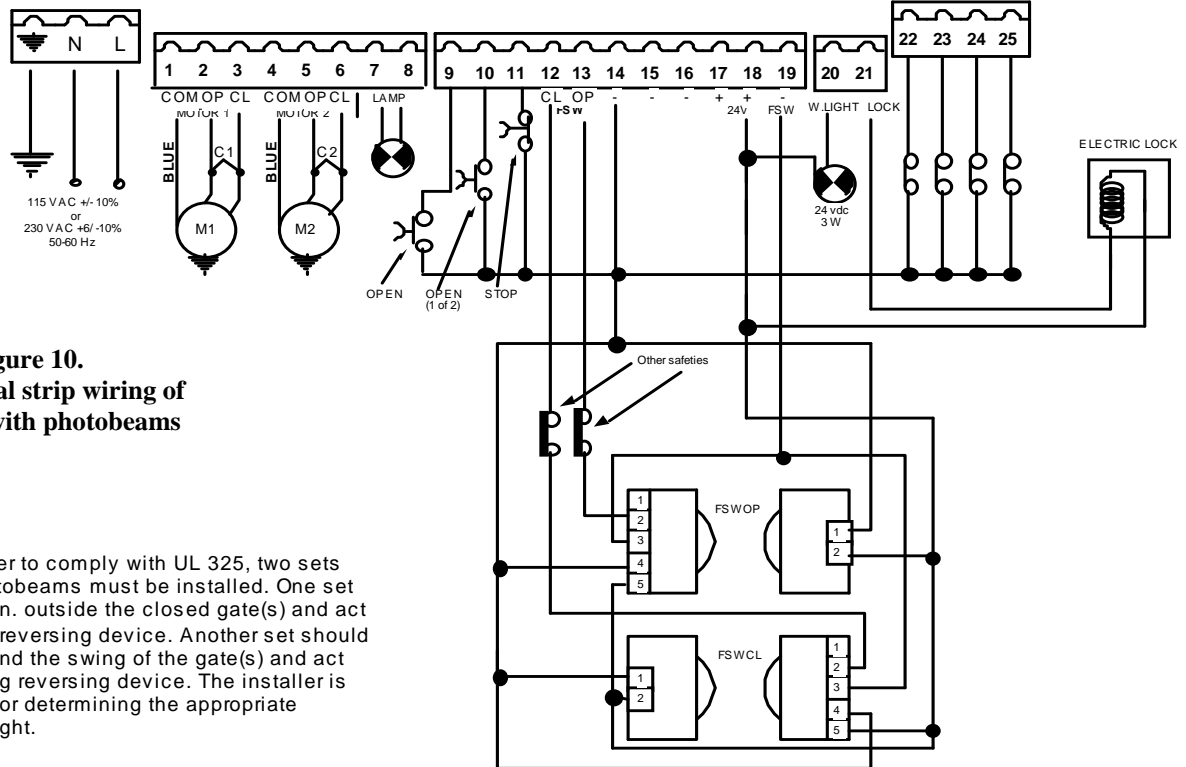

Figure 10.
The terminal strip wiring of
the 455 D with photobeams

NOTE: In order to comply with UL 325, two sets of FAAC photobeams must be installed. One set should be 6 in. outside the closed gate(s) and act as a closing reversing device. Another set should be 6 in. beyond the swing of the gate(s) and act as an opening reversing device. The installer is responsible for determining the appropriate mounting height.

You cannot check the motor's direction of rotation without these circuits (jumpers) or the accessories. When properly prepared for testing, the LEDs FSWOP, STOP, and FSWCL should be illuminated (see figure 12 on page 17).

WARNING! Running the operator—even for testing purposes—without a connected reversing device is potentially dangerous. Do not place yourself within the path of the moving gate during your test.

Disengage the operator(s) with the Manual Release key (see operator installation manual), and open the gate by hand about halfway.

Next, engage the operator(s) with the Manual Release key so that you can check the rotation of the motor(s).

To activate the operator(s) momentarily short across terminals labeled "OPEN DEVICES".

Turn on the main power and send an activating signal to the operator. The gate leaf (or leaves) should open. If a gate leaf closes, then you need to turn off the main power and reverse the connection of the red and black wires on terminal block for the operator controlling that leaf. Then you need to recheck the rotation direction again.

After having completed your test of the motor's direction of rotation, replace any test circuits you installed (between terminals between "PHOTO CL", and between "PHOTO OP/CL") with the proper reversing devices. The instructions for installing such accessories follow.

CONNECT OTHER DEVICES

WARNING! Turn the main power off before you make any electrical connections.

POWER SUPPLY FOR ACCESSORIES: You can access a 24 VDC output for supplying power to accessories through terminals (+) and 14 (-) on the pre-wired terminal block. In most cases, this source can be used to power 24 VDC accessories.

NOTE: The 455 D control panel allows a maximum accessory load of 800 mA.

REVERSING DEVICES: Reversing devices include photocells, inductive loops, and so forth. All of the reversing devices should have contacts of the normally closed (N.C.) type. Where you connect a device depends on whether you want the device to operate during opening or during closing.

NOTE: UL **does not** recognize the FAAC system with loop detectors or safety edges. FAAC photobeams must be used to comply with UL 325.

To wire photobeams, refer to page 19 (see "PHOTO OP/CL" for opening photobeams, and "PHOTO C/L" for closing photobeams). Photobeams must be connected as shown. See page 19 for the wiring of inductive loops. If using more than one reversing device, they must be wired in series.

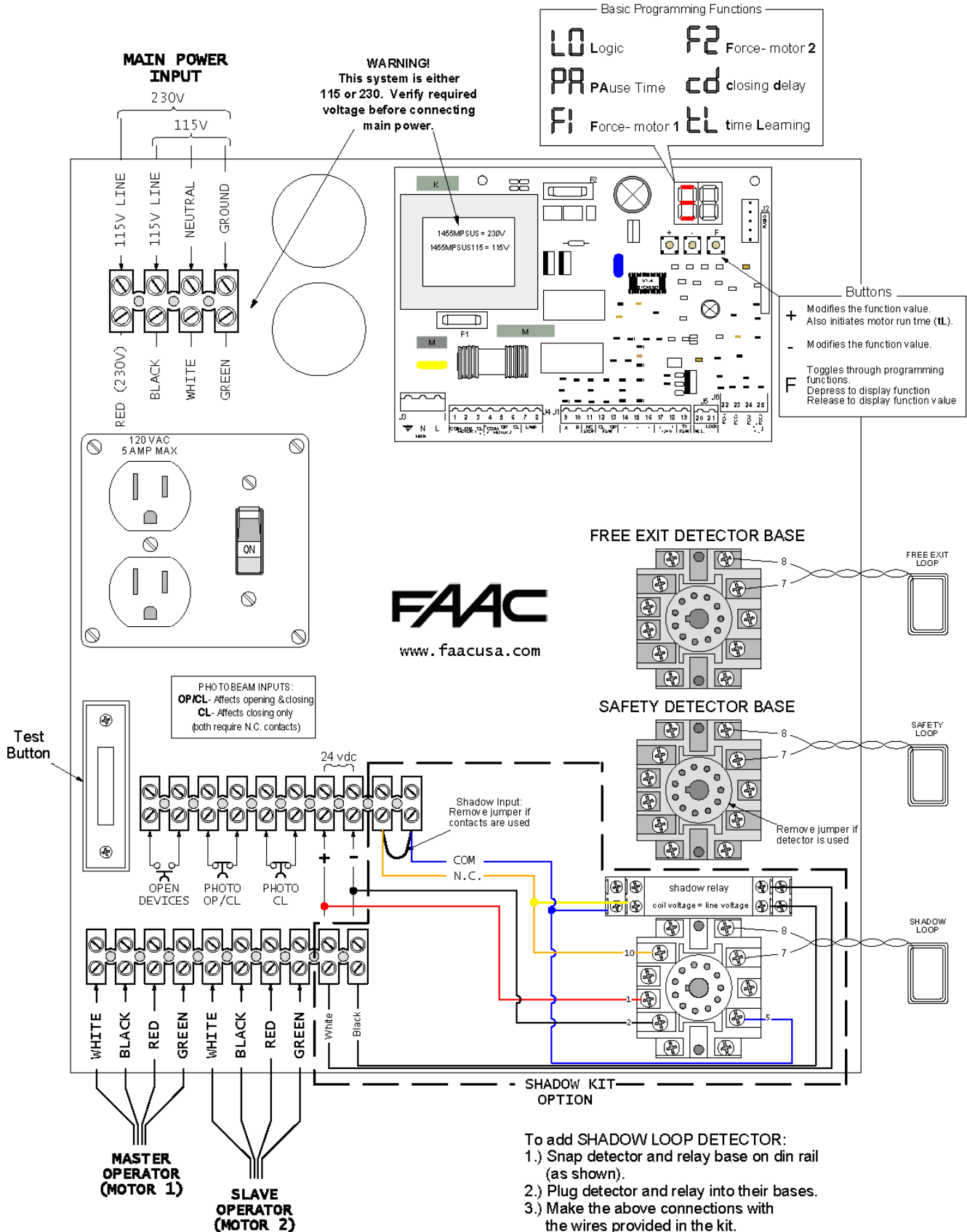

Figure 13. Pre-wired Enclosure with the 455 D Control Panel